

## SH-5 SERIES

### 1-1/2" 150LB ANSI FLANGE MOUNT SPDT SWITCH



The SH-5052 is a 1-1/2" - 150lb ANSI flange mount float operated level switch.

This design uses a pivoted float arm with a magnet on the inboard end. This magnet when moved by the rising float arm interacts with another magnet in the switch enclosure to give a snap action operation.

#### Features

- 1-1/2" - 150lb ANSI Flange
- SS 316L float material
- SS 304 other wetted parts material
- Available in direct switching version for use at up to 120°C
- Aluminium enclosure with screw on lid and cable gland

## SPECIFICATIONS

### Technical

<b>Mounting Style</b>	External via flange
<b>Float Material</b>	316L grade SS
<b>Maximum Temperature</b>	120°C
<b>Maximum Pressure</b>	10 bar
<b>Float SG</b>	0.55
<b>Minimum Fluid SG</b>	0.60
<b>Flange Size</b>	1-1/2"
<b>Flange Rating</b>	150lb
<b>Other Wetted Parts</b>	SS 304
<b>Cable Entry</b>	1/2" BSP
<b>Enclosure Rating</b>	IP65
<b>Sealing Gasket</b>	Not supplied

### Electrical

<b>Contact Form</b>		SPDT
<b>Switching Voltage AC Max</b>	V	250
<b>Switching Voltage DC Max</b>	V	120
<b>Switching Current Max</b>	A	5

All electrical ratings are for resistive loads only.

## STANDARD PARTS

	Material	Max Current	Temperature Range	Min SG	Mount
<b>SH-5052</b>	SS 316L/304	5	0 - 120°C	0.60	1-1/2"

Other flange types and pressure ratings may be possible. Please contact Sensata with your requirements.



## DIMENSIONS

All dimensions are in millimeters.

### SH-5052

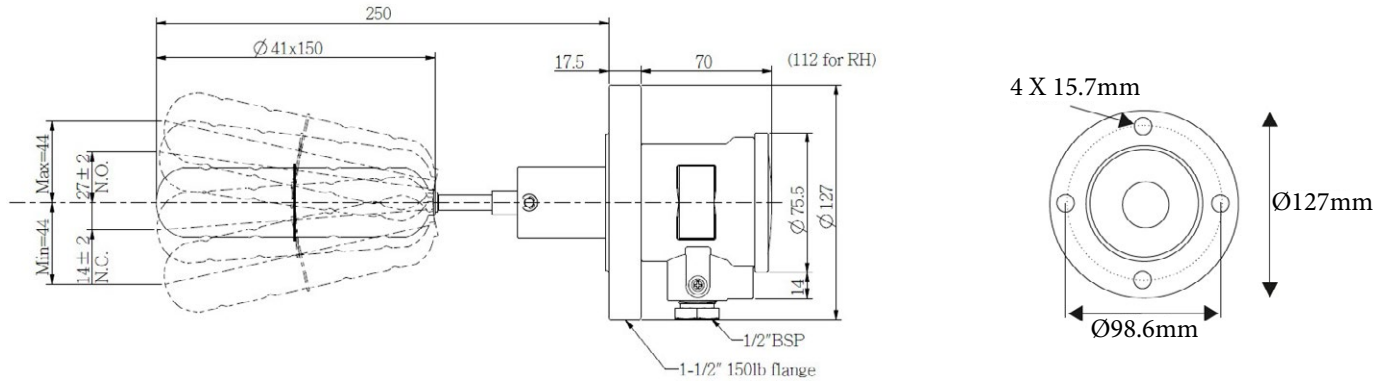

Made in the UK

Page 2

Datasheets provided by Sensata Technologies, Inc., its subsidiaries and/or affiliates ("Sensata") are solely intended to assist third parties ("Buyers") who are developing systems that incorporate Sensata products (also referred to herein as "components"). Buyer understands and agrees that Buyer remains responsible for using its independent analysis, valuation, and judgment in designing Buyer's systems and products. Sensata datasheets have been created using standard laboratory conditions and engineering practices. Sensata has not conducted any testing other than that specifically described in the published documentation for a particular datasheet. Sensata may make corrections, enhancements, improvements, and other changes to its datasheets or components without notice. Buyers are authorized to use Sensata datasheets with the Sensata component(s) identified in each particular datasheet. HOWEVER, NO OTHER LICENSE, EXPRESS OR IMPLIED, BY ESTOPPEL OR OTHERWISE TO ANY OTHER SENSATA INTELLECTUAL PROPERTY RIGHT, AND NO LICENSE TO ANY THIRD PARTY TECHNOLOGY OR INTELLECTUAL PROPERTY RIGHT, IS GRANTED HEREIN. SENSATA DATASHEETS ARE PROVIDED "AS IS". SENSATA MAKES NO WARRANTIES OR REPRESENTATIONS WITH REGARD TO THE DATASHEETS OR USE OF THE DATASHEETS, EXPRESS, IMPLIED, OR STATUTORY, INCLUDING ACCURACY OR COMPLETENESS. SENSATA DISCLAIMS ANY WARRANTY OF TITLE AND ANY IMPLIED WARRANTIES OF MERCHANTABILITY, FITNESS FOR A PARTICULAR PURPOSE, QUIET ENJOYMENT, QUIET POSSESSION, AND NON-INFRINGEMENT OF ANY THIRD PARTY INTELLECTUAL PROPERTY RIGHTS WITH REGARD TO SENSATA DATASHEETS OR USE THEREOF.

All products are sold subject to Sensata's terms and conditions of sale supplied at [www.sensata.com](http://www.sensata.com). SENSATA ASSUMES NO LIABILITY FOR APPLICATIONS ASSISTANCE OR THE DESIGN OF BUYERS' PRODUCTS. BUYER ACKNOWLEDGES AND AGREES THAT IT IS SOLELY RESPONSIBLE FOR COMPLIANCE WITH ALL LEGAL, REGULATORY, AND SAFETY-RELATED REQUIREMENTS CONCERNING ITS PRODUCTS, AND ANY USE OF SENSATA COMPONENTS IN ITS APPLICATIONS, NOTWITHSTANDING ANY APPLICATIONS-RELATED INFORMATION OR SUPPORT THAT MAY BE PROVIDED BY SENSATA.

Mailing Address: Sensata Technologies, Inc., 529 Pleasant Street, Attleboro, MA 02703, USA

### CONTACT US

+44 (0)1202 897969  
[support@sensata.com](mailto:support@sensata.com)  
Cynergy3 Components Ltd.  
7 Cobham Road,  
Ferndown Industrial Estate,  
Wimborne, Dorset,  
BH21 7PE, United Kingdom